

GWYOA Winter Concert

December 12, 2021

White Plains High School

550 North St, White Plains, NY 10605

Westchester Elementary Strings - Arrival 12:00 pm, Performance 1:00 pm

Westchester Junior Strings - Arrival 1:00 pm, Performance 2:00 pm

Westchester Youth Symphony - Arrival 2:15 pm, Performance 3:15 pm

Parking:

Two entrances available onto the WPHS campus. Park at the **Student Parking Lot**, the largest lot at WPHS.

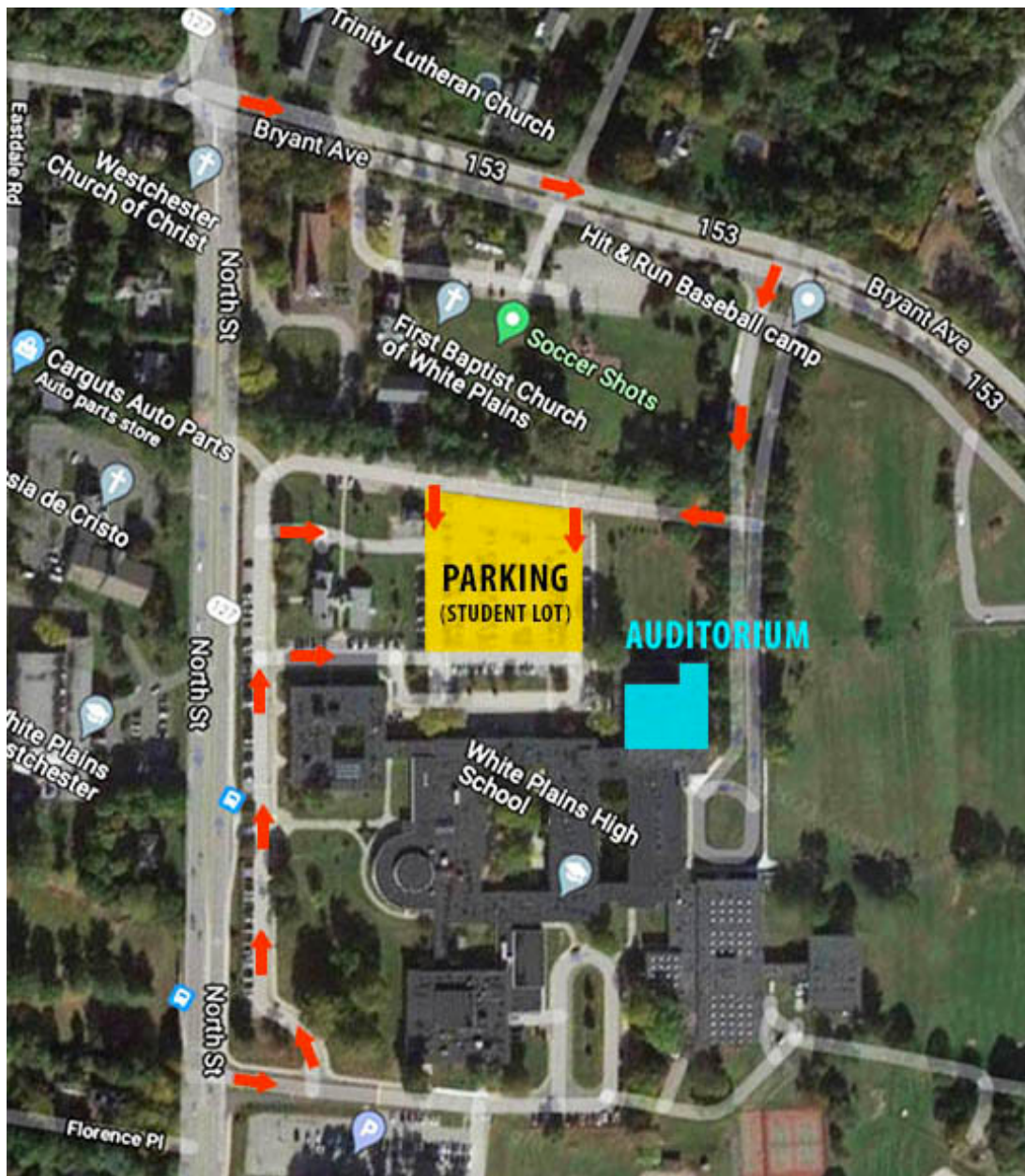

Musician Drop Off and Guest Entrance:

Look for the Auditorium sign



- Parents walk **musicians** to door **15** (on **left** side of auditorium entrance).
- Chaperones will be there to receive your musicians and perform a temperature check.
- **Guests** then enter building through door **13** (on **right** side of auditorium entrance) to the foyer waiting area.
- Chaperones will be present at door 13 to check guests **covid vaccination card** or **negative covid test**.

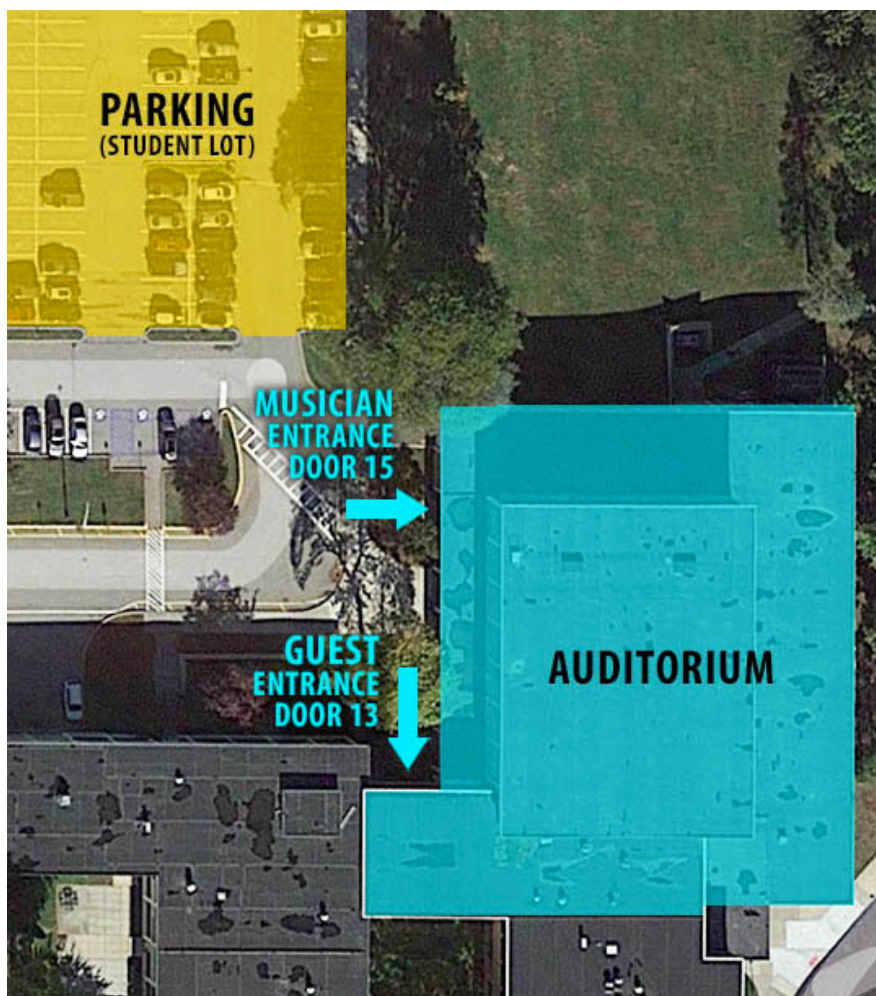

Ticket Sales, Will Call, Foyer Waiting Area:

Tickets may be purchased at the ticket tables. **Will Call** tickets will be available there as well.

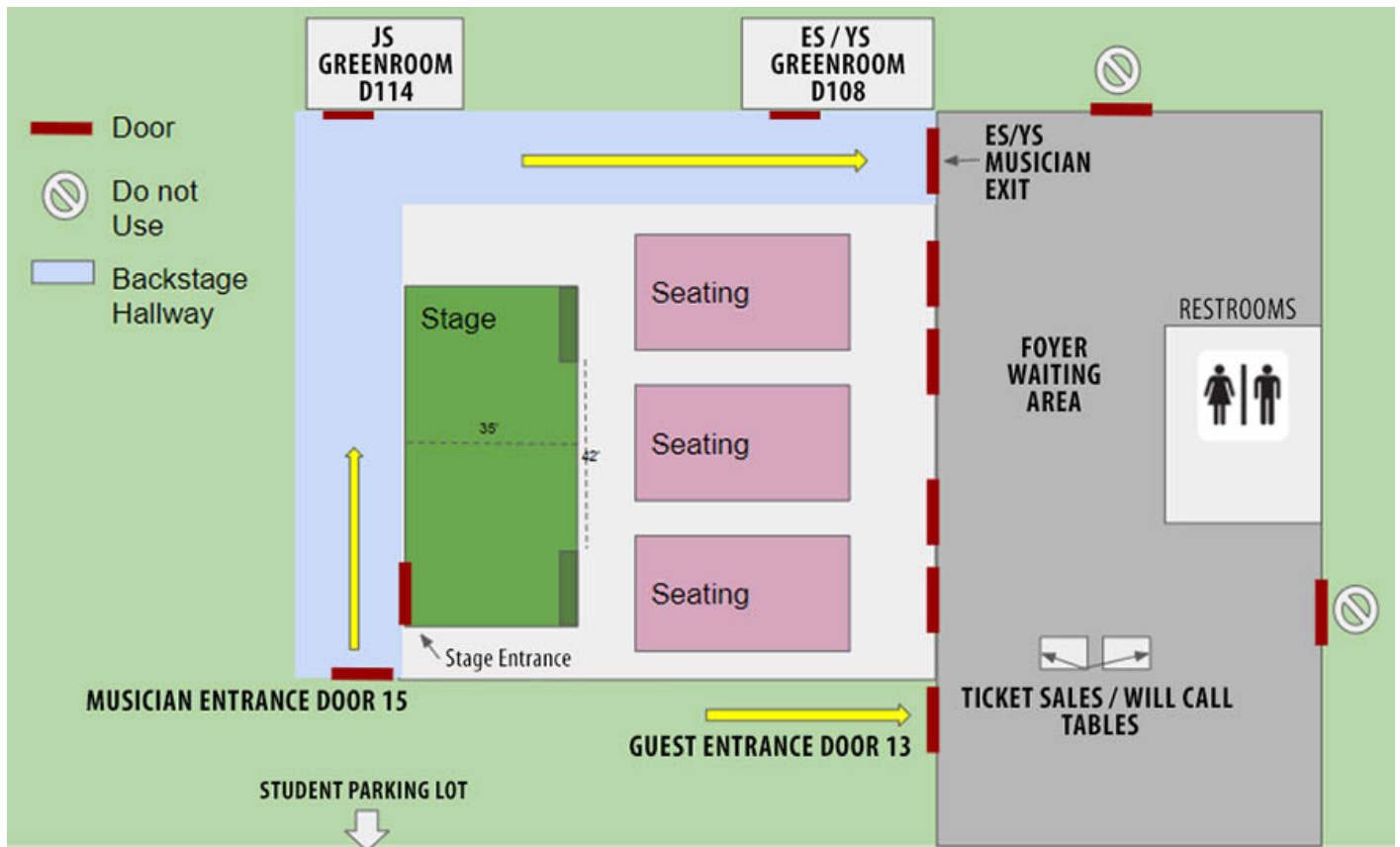

If you already have your tickets, please remember to social distance in the large foyer waiting area. Kindly allow older guests to use available seating.



Auditorium foyer waiting area

Auditorium Seating:

Seating in the auditorium is general admission. When choosing your seats, please leave two empty seats between your party and the one next to you. We will be using every other row in the auditorium.



Enjoy the performance!

Musician Dismissal:

After their performances, musicians will first head back to their greenrooms to gather their belongings, then dismiss as follows:

Elementary Strings – Your musicians will meet you in the **foyer waiting area**.

Junior Strings – Your musicians will meet you at **Door 15**, where you dropped them off.

Youth Symphony – Your musicians will meet you in the **foyer waiting area**.

Concert Attire-ES:

Black or navy pants, black socks and shoes, white shirt with conservative, straight tie, and black jacket. Shirts must be tucked inside pants.

-or-

All white blouses, black shoes, black bottoms (skirts must be knee length or longer).

Please note: Black leggings do not conform to this dress code. No athletic shoes/ sneakers.

Concert Attire-JS & YS:

Black pants, black socks and shoes, white shirt with conservative, straight tie, and black jacket. Shirts must be tucked inside pants.

OR: Black dress (3/4 sleeved or longer). Dress must be mid-calf to floor length. Black hose, black shoes.

OR: Black skirt (mid-calf to floor length) and black blouse (3/4 sleeved or longer). Black hose, black shoes.

OR: Black concert trousers and black blouse (3/4 sleeved or longer). Black socks and black shoes.

Tickets:

In order to expedite audience flow at the concert venue, we highly recommend purchasing tickets in advance by:

1) submitting a [Request Form](#) and

2) making your [PayPal payment](#)

- Tickets cost \$15 each. You only need to purchase (1) ticket for each guest for the entire concert. Musicians do not need a ticket to attend additional performance(s).
- Tickets are first come first served. Make sure you complete your purchase by submitting the [request form](#) AND making your [PayPal payment](#) (make sure you note musicians name before checking out).
- Purchased tickets will be available for pick-up at your designated musicians rehearsal check-in table beginning on **Monday, November 22**. Tickets not retrieved at rehearsals will be available at Will Call on the day of the concert (ticket table at the auditorium entrance).
- Seating is general admission.
- Additional tickets may be ordered by submitting the [request form](#) again and leaving a note in the Comments area, "additional tickets". Remaining tickets will be available for purchase at the venue.

Masks and Distancing:

Please wear a mask – all guests and musicians – at all times. (Brass & winds musicians may pull their masks down only while they are performing.)

Please maintain social distancing. Do not crowd while entering or exiting the auditorium. Leave a seat empty on either side of family parties.

Proof of COVID-19 Vaccination:

We strongly encourage the COVID-19 vaccination for all age-eligible students.

Performers:

We will collect proof of vaccination (2 shots of Pfizer/Moderna, 1 shot J&J) starting now for all students. Please email the photo or screenshot to the liaisons of your orchestra. On the day of the concert, temperatures will be taken at the door upon their arrival.

-or-

For unvaccinated students, they will need proof of a negative test within 72 hours prior to the concert which also can be emailed to liaisons or presented at the concert. On the day of the concert, temperatures will be taken at the door upon their arrival.

Guests:

Proof of vaccination for audience members (2 shots of Pfizer/Moderna, 1 shot J&J) or proof of negative test within 72 hours will be collected at the admission doors prior to the concert, along with temperature checks.

Types of COVID-19 tests:

Approved: NAAT (Nucleic Acid Amplification Test) tests

typically collected with a nasal or throat swab, or saliva

- **RT-PCR** (Reverse transcription polymerase chain reaction)
- **LAMP** (Loop-mediated isothermal amplification)
- **TMA** (Transcription mediated amplification)
- **NEAR** (Nicking endonuclease amplification reaction)

Not approved: Antibody tests, at home self test kits

Please feel free to contact your [orchestras liaisons](#) with any questions.